

_C LINE

GENERALCATALOGUE





Index

	Pag.
HYDRAULIC BOTTLE JACKS	4 - 7
HYDRAULIC TROLLEY JACKS	8 - 15
PORTABLE TROLLEY JACK	16 - 17
AIR HYDRAULIC BOTTLE JACK	18
PORTABLE AIR JACK	19
AIR HYDRAULIC GARAGE JACKS	20 - 21
FLOOR CRANES	22 - 27
HIGH LIFT TRANSMISSION JACKS	28 - 29
DESKTOP PRESSES	30 - 31
PRESSES	32 - 42
AIR HYDRAULIC JACKING BEAMS	43
PNEUMATIC PLATAFORM FOR MOTORCYCLES	44
HYDRAULIC LIFTING TABLES	45
WHEEL DOLLY	46
TRANSMISSION JACK	47
BODY ALIGNING SET	48
BODY REPAIR KITS	49
AXLE STANDS	50
TOE JACK	51
HYDRAULIC PIPE BENDERS	52 - 53

HYDRAULIC BOTTLE JACKS



1

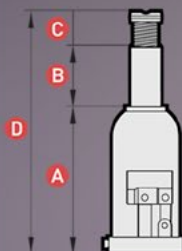

CAPACITY (t)	2	3	3	5	8	10	12	15	20	25	30	40	50	50	100
A	168	168	210	212	219	219	226	228	234	242	242	246	260	260	300
B	105	105	150	150	150	150	150	150	150	150	150	150	140	140	150
C	65	65	65	75	75	75	75	75	75	75	75	-	-	-	-
D	338	338	425	437	444	444	451	453	459	467	467	396	400	400	450
Weight (kg)	3,6	3,7	4	4,5	6,2	6,4	8,5	8,8	10,6	15,5	15,5	22,5	27	27	87
REFERENCES	BR2G	BR3G	BR3AG	BR5G	BR8G	BR10G	BR12G	BR15G	BR20G	BR25G	BR30G	BR40G	BR50G	BRD50G	BRD100G

Measures in mm.



BR10G

BR15G



BR20G



Rotatory pump socket.
It can be operated from
any position.

BR30G

BR_G LINE

HYDRAULIC BOTTLE JACKS

- Telescopic three piece zinc plated pump handle.
- Rotatory pump socket. It can be operated from any position.
- Rotatory carrying handle keeps retracted telescopic lever.
- Extension screw provides added lifting height.
- Safety overload valve which prevents the jack from being used beyond its rated capacity.
- Safety oil by-pass system prevents the ram from being over extended and causing damage to the cylinder.
- Pump handle can be locked.
- Under demand, a gauge can be adapted to the jack.

The MEGA jacks can be used horizontally when required.



Safety overload valve. Up to 5t.
Optional.



Hydraulic stroke limitation.



PATENTED

Complies with:
American ANSI PALD
Australian / New Zealand Standard
CE official certification



Telescopic three piece zinc plated pump handle.



Rotatory carrying handle from BR20G onwards.



BR50G

MEGA

Genuine since 1940

made in spain



The BRD50G and BRD100G jacks are fitted with two pumps (approach and operation)



BRD100G

2

HYDRAULIC BOTTLE JACKS

BRS_G LINE

SPECIAL BOTTLE JACKS

With the same technical features as those of our BR jacks. Designed to suit special applications. The lower height of the BRS jacks facilitates easy access to low jacking points. However, the BR2LG is used for vehicles with a high jacking point.



CAP(t)	2	2	3	5	5	10	15	20
A	570	297	172	212	135	131	150	190
B	460	225	105	150	70	62	75	105
C	-	-	65	75	40	30	40	55
D	1030	522	338	437	245	223	225	350
Weight (kg)	10,3	6	3,8	4,7	3,7	5	7,2	9,5
REF	BR2LLCG	BR2LG	BR3EMG	BR5EMG	BR55G	BR510G	BR515G	BR520G

Measures in mm.



BR2LLCG



BR2LG



BR5EMG



BR510G

BRT_G LINE

MEGA

Genuine since 1940

made in spain



Safety overload valve. Up to 5t.
Optional.



Hydraulic stroke limitation.

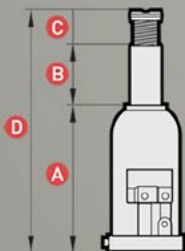

CAP (t)	1,2	2	2	2	5	12	20
A	160	145	145	170	215	245	180
B	230	165	165	212	300	326	205
C	-	50	50	-	-	-	-
D	390	360	360	382	515	571	385
Weight (kg)	5	4,8	5	5,4	8,3	15,4	22
REF	BRT1.2G	BRT2G	BRT2MIG	BRT2EMG	BRT5G	BRT12G	BRT20G

Measures in mm.

TELESCOPIC BOTTLE JACKS

They include the same technical improvements as our BR jacks. A telescopic piston allows for a very low initial height with a high lifting range.

The EM jacks are fitted with a specific lifting support for vehicles requiring this type of jacking head.

Other designs of jacks with special technical requirements can be manufactured on request, depending on quantities ordered. We also supply jacks fitted with a pressure gauge.



BRT1.2G



BRT2G



BRT2EMG



BRT12G

HYDRAULIC TROLLEY JACKS

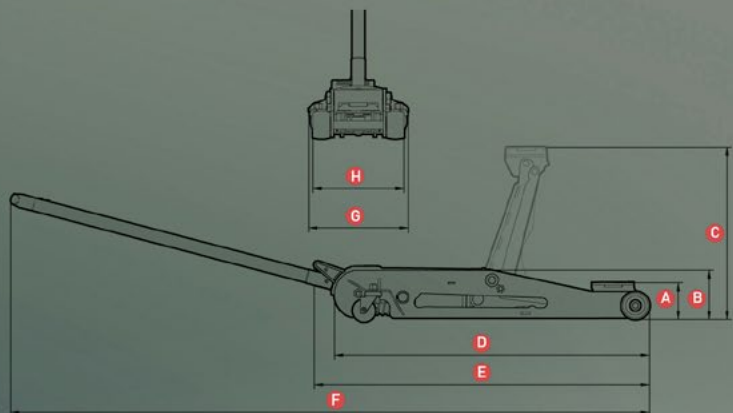

CAPACITY (t)	2	2	2	2
A	90	90	90	75
B	135	135	165	137,5
C	470	470	790	520
D	850	850	1220	920
E	905	905	1275	975
F	1720	1720	2020	1800
G	270	270	270	270
H	250	250	360	250
Weight (kg)	30	32,5	50,7	35,5
REF.	GR2G	GR2SG	GR2HG	GR2XG

Measures in mm.



GR2HG

Extra long low profile frame grants maximum accessibility.

Easily accessible thanks to a very low chassis.
(135 mm at their highest point **B**)

HYDRAULIC TROLLEY JACKS

- All models are fitted with polyamide wheels and castors to facilitate manoeuvrability. These wheels will not damage garage floors, do not rust and are quiet in operation.



Hydraulic stroke limitation.



Safety overload valve.



LCS lowering system.



Operation by the "dead man's" principle.



The inside wheels in all models allows for excellent manoeuvrability.

GR_C LINE



- 1 - Foot pedal releases the mechanical safety system. **Patented.**
- 2 - Foot pedal for quick approach of lifting saddle to load.



New **GR25G** model incorporates a mechanical safety system that prevents from accidental lowering. Should it occur, the lifting arm will lock at 320 mm from the floor.

MEGA

Genuine since 1940

made in spain



**BUREAU
VERITAS**

Complies with:
European Standard EN1494
American ANSI PALD
Australian / New Zealand Standard



GR2XG

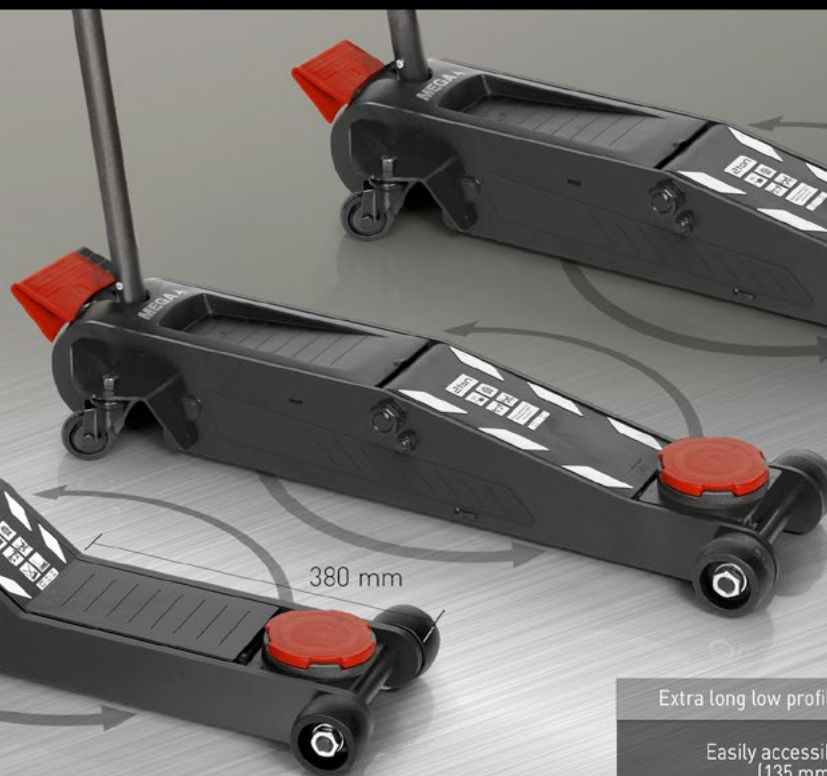

380 mm

GR20

GR25G

Extra long low profile frame grants maximum accessibility.

Easily accessible thanks to a very low chassis.
(135 mm at their highest point)

HYDRAULIC TROLLEY JACKS



HYDRAULIC TROLLEY JACKS

- All models are fitted with polyamide wheels and castors to facilitate manoeuvrability. These wheels will not damage garage floors, do not rust and are quiet in operation.



Operation by the "dead man's" principle (the operation is halted if the user accidentally loses control)



Safety overload valve. Prevents the jack from being used beyond its rated capacity.



Hydraulic stroke limitation. Safety oil by-pass system prevents the ram from being over extended and causing damage to the cylinder.



LCS lowering system. A system that functions automatically and offers smooth and uniform lowering. It guarantees safe lowering in all circumstances, although an involuntary and/or abrupt and violent opening of the release valve is produced.

4

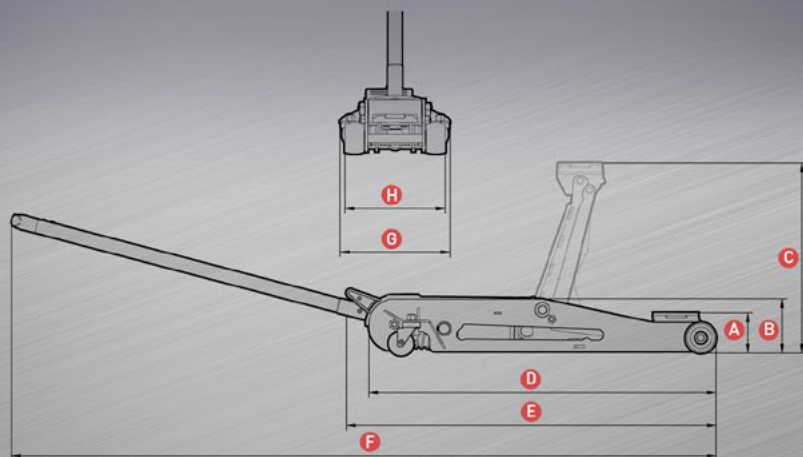

CAPACITY (t)	3	3	3
A	90	90	90
B	135	135	140
C	470	470	520
D	850	850	920
E	905	905	975
F	1720	1720	1810
G	270	270	270
H	250	250	250
Weight (kg)	33,5	36	38
REF.	GR3G	GR3SG	GR3XG

Measures in mm.



The inside wheels in all models allows for excellent manoeuvrability.

GR_C LINE



BUREAU
VERITAS

Complies with:
European Standard EN1494
American ANSI PALD
Australian / New Zealand Standard



New **GR35G** model incorporates a mechanical safety system that prevents from accidental lowering. Should it occur, the lifting arm will lock at 320 mm from the floor.

MEGA

Genuine since 1940

made in Spain



- 1 - Foot pedal releases the mechanical safety system. **Patented.**
- 2 - Foot pedal for quick approach of lifting saddle to load.

Easily accessible thanks to a very low chassis.
(135 mm at their highest point B)

GR3XC

360 mm

GR35G

GR30

The inside wheels in these models allows for excellent manoeuvrability.

HYDRAULIC TROLLEY JACKS



5



CAP. (TON)	3	3	3
A	90	90	90
B	135	135	140
C	470	470	520
D	850	850	920
E	905	905	975
F	1720	1720	1810
G	270	270	270
H	250	250	250
Weight (kg)	33,5	33,5	38
REF.	S63	S63S	S63X

Measures in mm.

LCS lowering system.

Operation by the "dead man's" principle.

Hydraulic stroke limitation.

Safety overload valve.

CAP. (TON)	2	2	2	2
A	90	90	90	75
B	135	135	165	137,5
C	470	470	790	520
D	850	850	1220	920
E	905	905	1275	975
F	1720	1720	2020	1800
G	270	270	270	270
H	250	250	360	250
Weight (kg)	30	30	50,7	35,5
REF.	S62	S62S	S62H	S62X

Measures in mm.

HYDRAULIC TROLLEY JACKS

- All models are fitted with polyamide wheels and castors to facilitate manoeuvrability. These wheels will not damage garage floors, do not rust and are quiet in operation.

S63

S63X

S63S

360 mm

SG LINE



BUREAU
VERITAS

Complies with:
European Standard EN1494
American ANSI PALD
Australian / New Zealand Standard



Ergonomic handle.
You can choose this
handle as an option,
and the hydraulic
jack becomes the SG line.



New SG25 and SG35 model incorporates a mechanical safety system that prevents from accidental lowering. Should it occur, the lifting arm will lock at 320 mm from the floor.

MEGA

made in spain



- 1 - Foot pedal releases the mechanical safety system. **Patented.**
- 2 - Foot pedal for quick approach of lifting saddle to load.

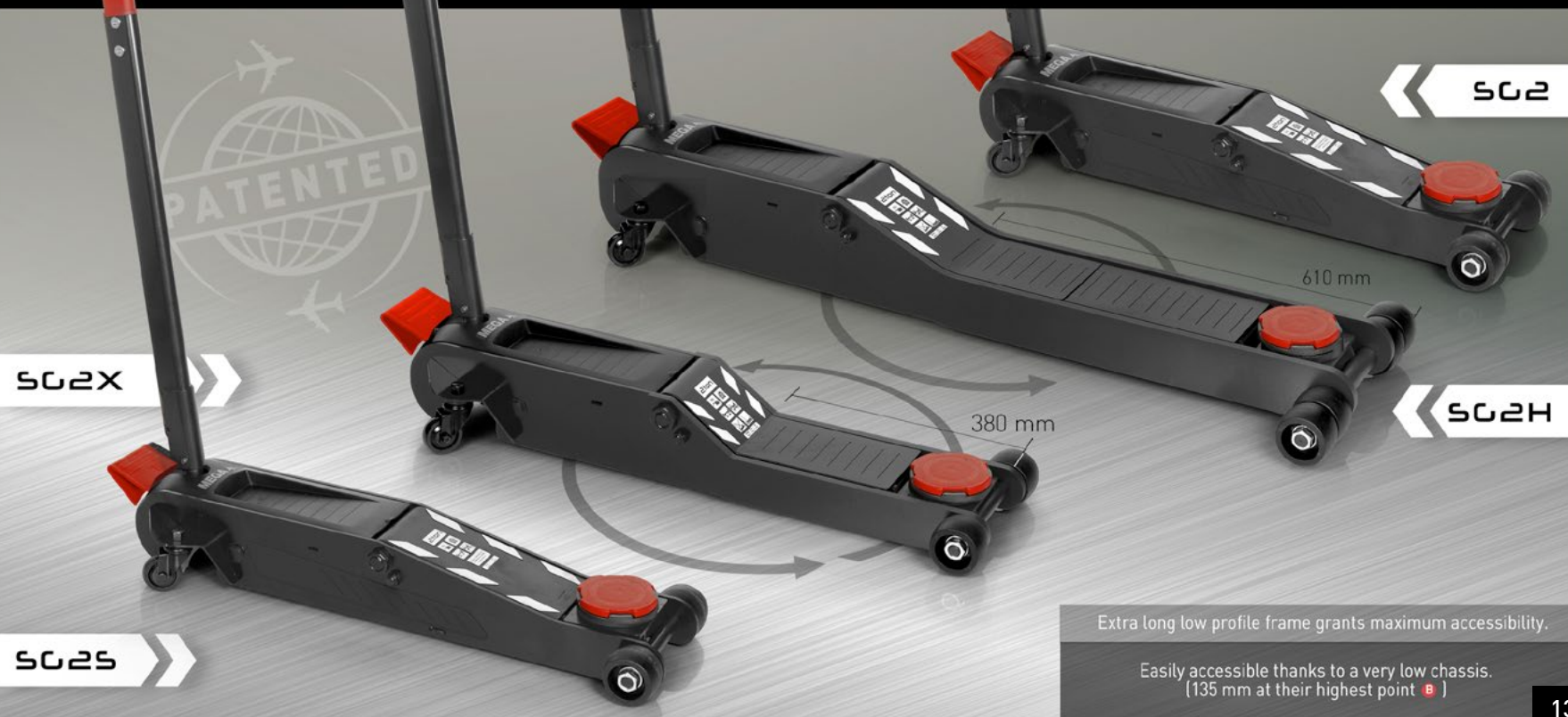

SG2X

SG2

610 mm

SG2H

380 mm

SG25

Extra long low profile frame grants maximum accessibility.

Easily accessible thanks to a very low chassis.
(135 mm at their highest point ■)

HYDRAULIC TROLLEY JACKS



T_G LINE

HYDRAULIC TROLLEY JACKS

- Optimum use and distribution of material thanks to the rear side openings and front side reinforcements.
They lift everything from cars to heavy duty trucks.
Intended use: truck fleet, bus company garages, heavy construction and agricultural equipment maintenance garages.
- Spring loaded handle can be activated to lower load in any handle position by pulling and rotating it clockwise ¼ turn.
- Huge steel wheels at mid-weight point for easy manoeuvring.
Note: model not shown (T12G) has same basic construction as model pictured (T10G).

CAPACITY (t)	6	10	12	15	20
A	170	170	190	195	200
B	220	270	270	265	310
C	580	605	580	600	615
D	1250	1535	1482	1575	1585
E	1310	1600	1550	1750	1777
F	2215	2530	2480	2680	2707
G	414	414	414	375	415
H	336	386	386	255	302
Weight (kg)	81	120,5	123	145	234,5
REFERENCES	T6G	T10G	T12G	T15G	T20G

Measures in mm.

6

T15G

T20G

T6G

T10G

The big size models are fitted with steel wheels.

GR4G LINE

MEGA

Genuine since 1940

made in spain

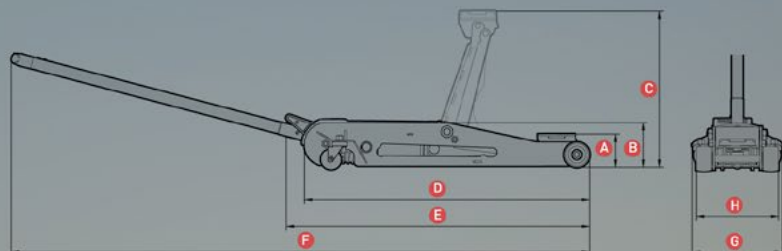

CAPACITY (t) 4

A 140

B 192

C 530

D 1120

E 1175

F 1970

G 275

H 260

Weight (kg) 42,5

REFERENCE GR4G

Measures in mm.

HYDRAULIC TROLLEY JACK GR4G MODEL

- **GR4G** intended use: vans, minibuses, 4 wD's. It substitutes in technical characteristics to our old T3 model.
- For 3 ton models we have created a complete new range (see previous page).

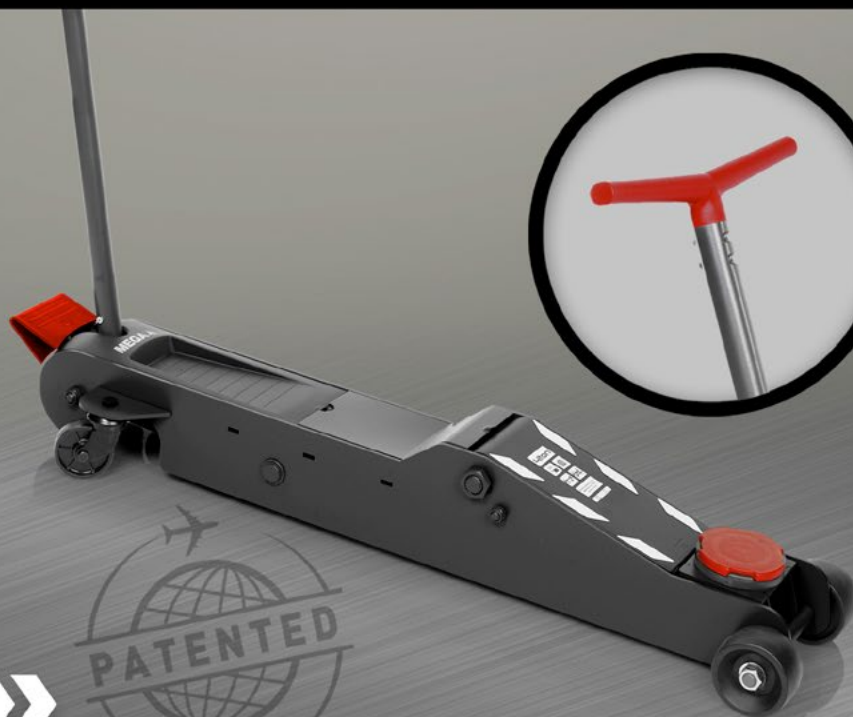

GR4G



Tools holding tray.



BUREAU
VERITAS
Complies with:
European Standard EN1494

PORTABLE TROLLEY JACK



7



Operation by the "dead man's" principle (the operation is halted if the user accidentally loses control)



Safety overload valve. Prevents the jack from being used beyond its rated capacity.



Hydraulic stroke limitation. Safety oil by-pass system prevents the ram from being over extended and causing damage to the cylinder.



LCS lowering system. A system that functions automatically and offers smooth and uniform lowering. It guarantees safe lowering in all circumstances, although an involuntary and/or abrupt and violent opening of the release valve is produced.



Hook to fix handle for transport.

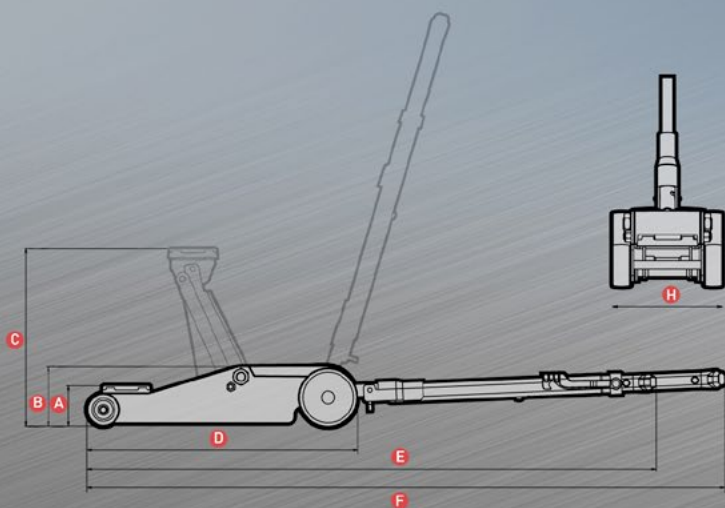

CAP. (TON) 2

A 92

B 136

C 410

D 616

E 1295

F 1450

H 200

WEIGHT (kg) 19

REF. SGP2

Measures in mm.



Dual pump for fast lift.

SCP LINE

MEGA



BUREAU
VERITAS

Complies with European Standard EN1494

PORTABLE TROLLEY JACK

- Portable trolley jack.
- Only **19 kg** maximum weight handle included.
- 100% made of steel.
- Without resorting to aluminium so as not to reduce the strength of the jack and its useful life.
- Dual pump for fast lift.

Genuine since 1940

made in spain

Foldable telescopic handle, includes all functions: lifting, lowering and transport. **Patented.**

Different transport options.
The jack rest in vertical position. **Patented.**

PATENTED

SCP2

Tools holding tray.

AIR HYDRAULIC BOTTLE JACK

BRA_C LINE

8

AIR HYDRAULIC BOTTLE JACK

- They are very compact models. Their monoblock -integrated tank- unweld construction reduces their dimensions and makes transportation easier.
- Ideal for road size services.
- The pistons are hardened with a salt bath nitriding treatment to ensure a long working life.
- They have a fast load approach screw and a high performance pneumatic pump with remote control drive.



BUREAU
VERITAS

Complies with:
American ANSI PALD / EN 1494



A-5270



Safety overload valve. Prevents the jack from being used beyond its rated capacity.



Hydraulic stroke limitation. Safety oil by-pass system prevents the ram from being over extended and causing damage to the cylinder.



Rotatory pump socket.
It can be operated from any position.

BRA30G



ESSENTIAL!
Workshop in-line air
filter-regulator-lubricator.
Optional.

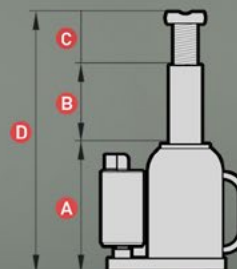

CAPACITY (t)	20	30
A	234	242
B	138	138
C	75	75
D	447	455
Weight (kg)	15,5	23,5
Air pressure required	7 bar / 100 psi	
Necessary air flow	270 l/min / 9,5 cfm	
REFERENCES	BRA20G	BRA30G

Measures in mm.

PORTABLE AIR JACK

NP_C LINE

MEGA

Genuine since 1940

made in spain

A-5212
L=100mm. Standard

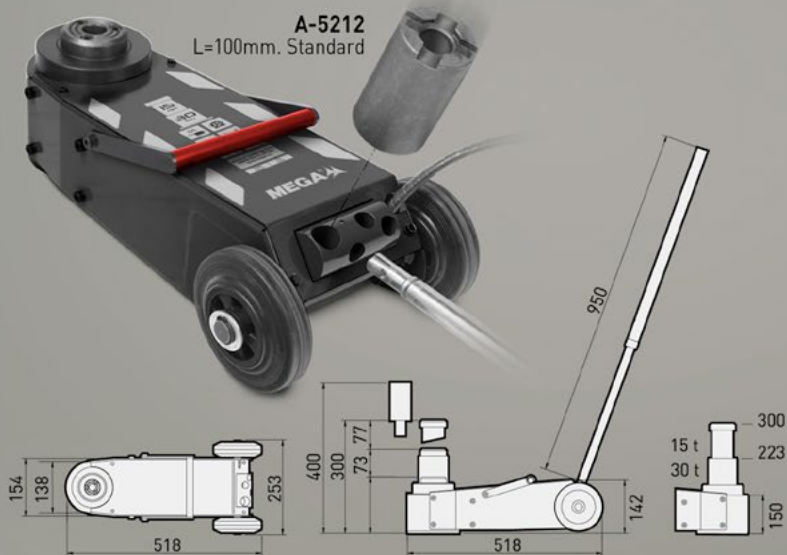

PORTABLE AIR JACK

- This model shares technology, concept and performance as our N15-30 models (same engine, same hydraulic block, etc,...) The unique difference is that we have integrated the oil tank into the frame so as to make it more compact, and to make the chassis extraordinarily robust and rigid.
- Without resorting to aluminium, so as not to reduce the strength of the jack and its useful life, we have achieved the balance of excellent weight while maintaining its exceptional load capacity for its category, 15 - 30 t.
- The most compact, robust and practical model in the market.

PORTABLE AIR JACK (SAP)

NP15-2BC



The telescopic lever has three positions:
A and B, for moving, C, position for working.



BUREAU
VERITAS
EN 1494

AIR HYDRAULIC GARAGE JACKS



BUREAU
VERITAS

EN1494

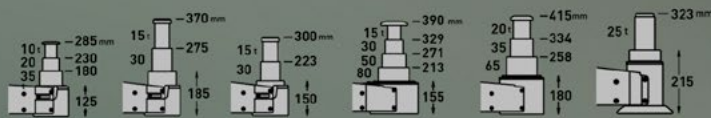

CAPACITY (t)	10-20-35	15-30	15-30	15-30-50-80	20-35-65	25
A	807	807	807	810	793	560
B	160	185	150	235	235	108
C	345	470	400	490	515	423
D	157	157	157	212	194	157
E	260	280	280	317	317	280
Weight (kg)	41	46,5	43,5	70,5	69,5	47
REFERENCES	N10-3G	N15-2G	N15-2BG	N15-4G	N20-3G	N25G

Measures in mm.



Operation by the "dead man's" principle (the operation is halted if the user accidentally loses control)



Safety overload valve. Prevents the jack from being used beyond its rated capacity.



Hydraulic stroke limitation. Safety oil by-pass system prevents the ram from being over extended and causing damage to the cylinder.



LCS lowering system. A system that functions automatically and offers smooth and uniform lowering. It guarantees safe lowering in all circumstances, although an involuntary and/or abrupt and violent opening of the release valve is produced.

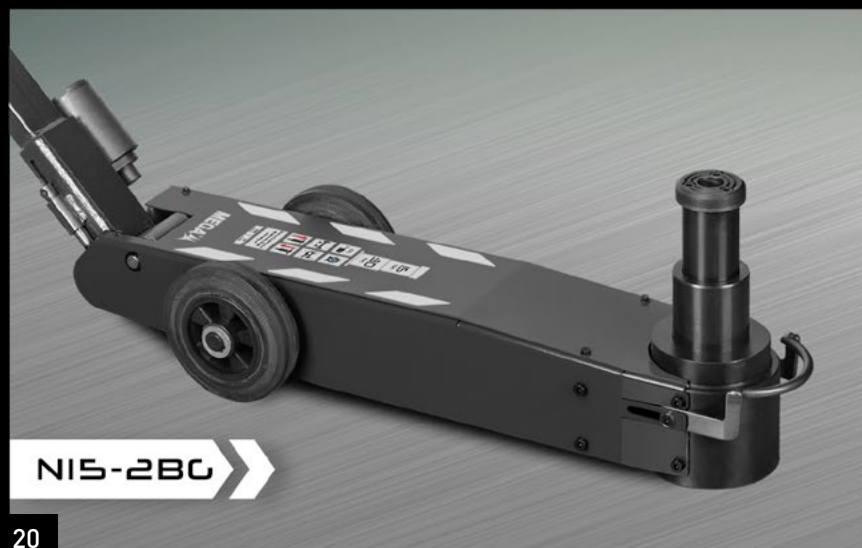
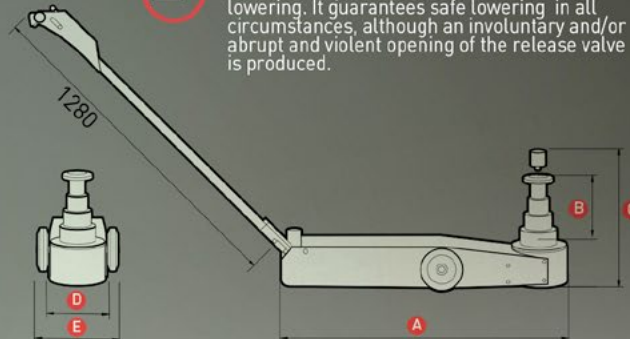

N15-2BG



N15-4G

N_G LINE

MEGA

Genuine since 1940

made in spain

Rotating or retractable handle depending on models.



A-5270

ESSENTIAL!
Workshop in-line air
filter-regulator-lubricator.
Optional.



Single control switch.
Handy and easy to use.

AIR HYDRAULIC GARAGE JACKS

- Maximum steel quality. Their chromium molybdenum vanadium composition strengthened by an anti-rust and anti-seizing treatment through salt bath nitriding gives the jacks unbeatable resistance and durability properties.
- Modular concept. The independent modular construction design -lifting block, valve unit, pump motor, release cylinder and tank- simplifies assembly and makes maintenance easier.
- High approach speed and efficient load elevation.
The operator will always be in control of the operation even if the air supply is interrupted.

N15-20

A-5204 - Optional

A-5206
L=50mm. Optional

A-5212
L=100mm
Standard

N10-30

A-5211
L=60mm
Standard

A-5205
L=100mm.
Optional

ONLY FOR N10-30

N20-30

N250



FLOOR CRANES

10

FLOOR CRANES

- All models are fitted with polyamide wheels and castors to facilitate manoeuvrability. These wheels will not damage garage floors, do not rust and are quiet in operation.
- The extendable jib changes position at the pushing of a button. It has a handle and a window to show jib position.
- A foot pedal facilitates the in-shop handling of the crane.



Operation by the "dead man's" principle (the operation is halted if the user accidentally loses control)



Safety overload valve. Prevents the jack from being used beyond its rated capacity.



Hydraulic stroke limitation. Safety oil by-pass system prevents the ram from being over extended and causing damage to the cylinder.



LCS lowering system. A system that functions automatically and offers smooth and uniform lowering. It guarantees safe lowering in all circumstances, although an involuntary and/or abrupt and violent opening of the release valve is produced.

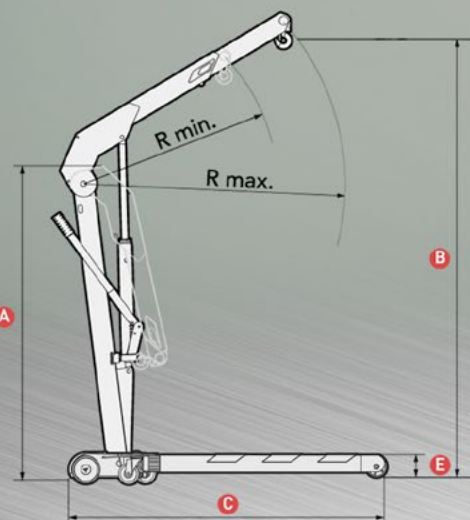

CAP. (Kg)	650	1000	2000
A	1580	1580	1740
B	2200	2200	2460
C	1480	1580	1920
D	820	970	1080
E	112	112	150
R Minimum	960	960	1200
R Maximum	1300	1300	1610
G	530	530	700
Weight [kg]	75	83	140
REF.	CRV6G	CRV10G	CRV20G

Measures in mm.

CRV_G LINE



These models are easy to fold and require only a small parking space. Folding of crane can be easily and safely done by one single person. Auxiliary wheels for easy handling when folded. Transport is much easier and safe when folded.

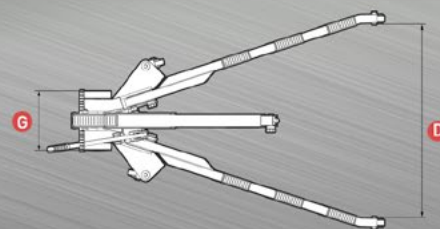

CE

MEGA

Genuine since 1940

made in Spain



BUREAU
VERITAS

Certificación
Oficial CE



Window to show safe working load at the selected position.
Push button for quick change of position of the extendible jib. **Patented.**

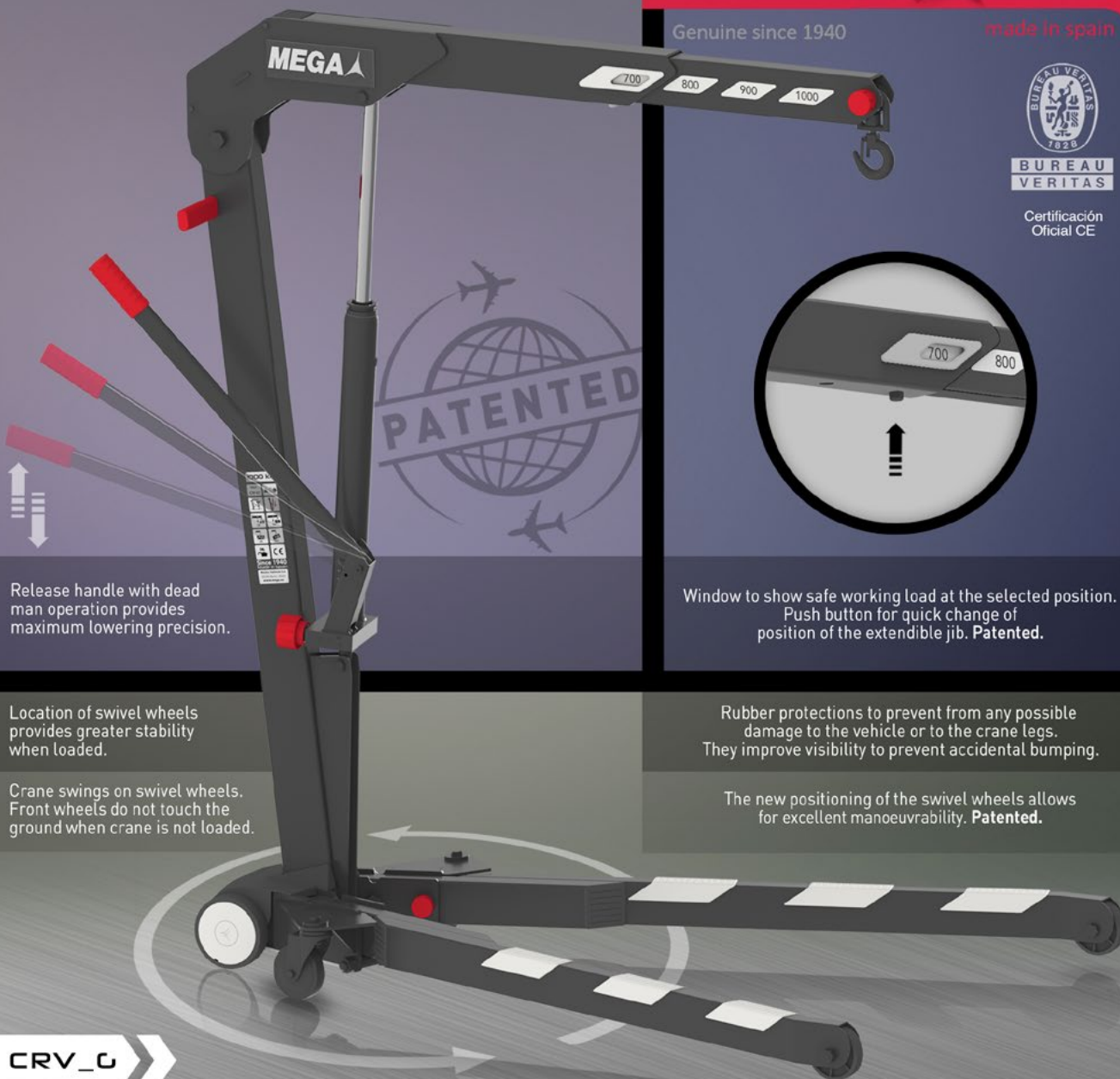

Release handle with dead man operation provides maximum lowering precision.

Location of swivel wheels provides greater stability when loaded.

Crane swings on swivel wheels. Front wheels do not touch the ground when crane is not loaded.

Rubber protections to prevent from any possible damage to the vehicle or to the crane legs. They improve visibility to prevent accidental bumping.

The new positioning of the swivel wheels allows for excellent manoeuvrability. **Patented.**

CRV_C

Swivel hydraulic unit. The pump piston spring improves operation.

Double tube legs provide more stability, strenght and accesibility.

FLOOR CRANES

11

FLOOR CRANES

- All models are fitted with polyamide wheels and castors to facilitate manoeuvrability. These wheels will not damage garage floors, do not rust and are quiet in operation.
- The extendable jib changes position at the pushing of a button. It has a handle and a window to show jib position.
- A foot pedal facilitates the in-shop handling of the crane.



LCS lowering system.



Operation by the "dead man's" principle.



Safety overload valve.



Hydraulic stroke limitation.

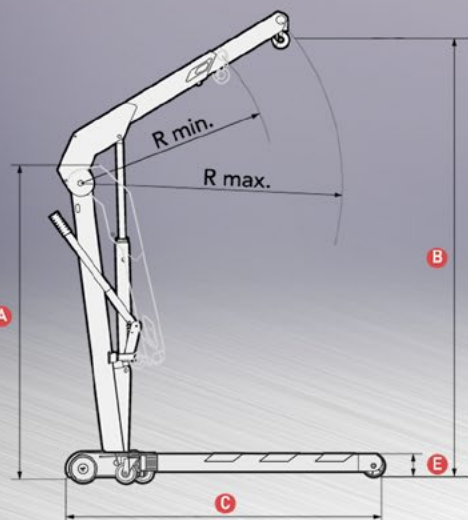

CAP. (Kg)	1000	2000
A	1580	1740
B	2200	2460
C	1480	1750
D	860	1080
E	112	150
R Minimum	960	1200
R Maximum	1300	1610
G	300	300
Weight (kg)	81	145
REF.	CRP10G	CRP20G

Measures in mm.

CRP_G LINE



These models are easy to fold and require only a small parking space. Folding of crane can be easily and safely done by one single person. Auxiliary wheels for easy handling when folded. Transport is much easier and safe when folded.

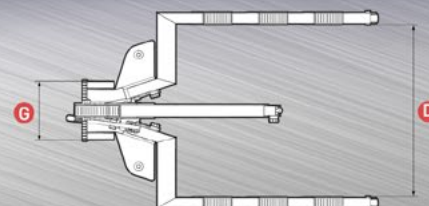

CE



PATENTED

The extendable jib changes position at the pushing of a button. It has handle and window on lifting arm shows jib position and safe working load. **Patented.**

Rubber protections to prevent from any possible damage to the vehicle or to the crane legs. They improve visibility to prevent accidental bumping.

Crane swings on swivel wheels. Front wheels do not touch the ground when crane is not loaded. Maximum maneuverability. **Patented.**

CRP_G

MEGA

Genuine since 1940

made in spain



**BUREAU
VERITAS**

Certificación
Oficial CE



Parallel legs version grants extra functionality.



The new positioning of the swivel wheels allows for excellent manoeuvrability. **Patented.**

FLOOR CRANES



CRM200



LCS lowering system.



Operation by the "dead man's" principle.



Safety overload valve.



Hydraulic stroke limitation.

12

CRM_G LINE



CRM300

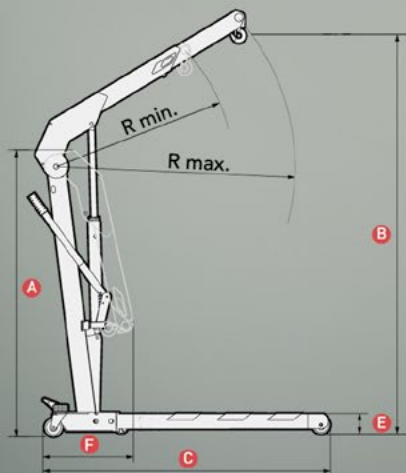

CAPACITY (kg)	2000	3000
A	1690	200
B	2470	2920
C	1870	2150
D	820	1120
E	200	265
R Minimum	1275	1620
R Maximum	1570	1910
F	-	-
G	-	-
Weight (kg)	180	302
REF.	CRM20G	CRM30G

Measures in mm.



The 3t model, CRM30G, is fitted with a two piston pump.

FLOOR CRANES

- All models are fitted with polyamide wheels and castors to facilitate manoeuvrability.
- These wheels will not damage garage floors, do not rust and are quiet in operation.
- The extendable jib changes position at the pushing of a button.
- It has a handle and a window to show jib position.

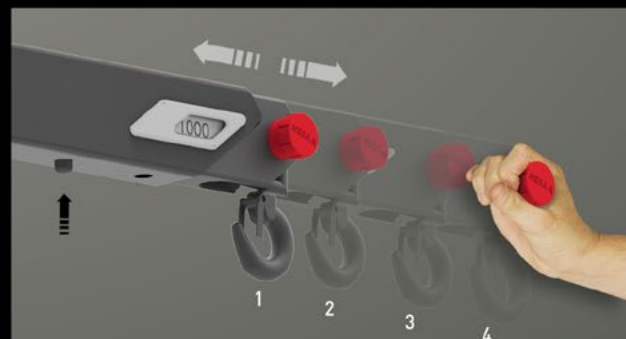

The extendable jib changes position at the pushing of a button. It has handle and window on lifting arm shows jib position and safe working load. **Patented.**

POSITION (kg)	1	2	3	4
REF.	SAFE WORKING LOAD			
CRV6G	650	550	450	350
CRV10G/CRP10G	1000	900	800	700
CRV20G/CRP20G	2000	1750	1650	1250
CRM20G	2000	1750	1650	1250
CRM30G	3000	2500	2300	-



CAP. (Kg) 650 1000 2000

REF. A-5127 A-5127 A-5128

Mechanical safety accessory that works automatically and eliminates any possibility of unintentional or accidental lowering.



A-5298

Load leveler. **Optional.**



AB-300

Drum lifting clamp. For 200 litre steel drums. Only for tight head drums or removable top drums with covers locked in place. **Optional.**

HIGH LIFT TRANSMISSION JACKS

HIGH LIFT TRANSMISSION JACKS

- For use in pits and underneath elevated vehicles.
- The lifting and lowering of the load using the foot pedals allow the hands to be free for other jobs.
- Easy manoeuvrable thanks to the swivel castors. The large base size provides high stability under load.
- With ergonomic handle.



Operation by "dead man's" principle.



Safety overload valve.



Hydraulic stroke limitation.



LCS lowering system. A system that **functions automatically** and offers smooth and uniform lowering. It guarantees safe lowering in all circumstances, although an involuntary and/or abrupt and violent opening of the release valve is produced.

CAP. (kg)	300	500	750	1200	1200
A	1140	1110	1110	1110	825
B	850	820	820	815	1000
C	315	315	315	315	315
D	1990	1930	1930	1925	1825
E	60	60	60	60	60
F	610	720	720	720	720
Weight (kg)	25,2	34,2	33,2	35,2	36,2

REF. TR5300G TR5500G TR5750G TR51200G TTR51200G

Measures in mm.

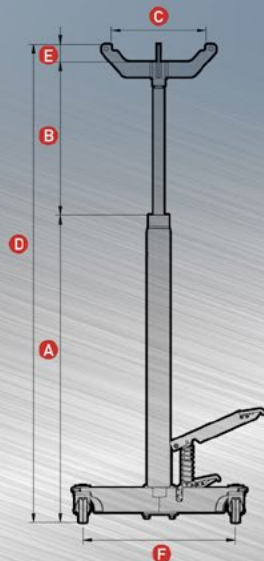

TRS_G LINE



Handle with screws folding tray.



Made in Spain. Since 1940.



Block of foam to protect vehicle parts. **Patented.**

Adjustable saddle with chains. **Optional.**

CE

TTR51200C

MEGA

made in spain



BUREAU
VERITAS

Comply with:
EN 1494

Unique high lift transmission jack
with all functions operated by foot.
Maximum stability, comfort
and functionality.
New release with dead man operation
provides maximum lowering precision.



Rubber protections to prevent from any
possible damage to the vehicle or to
the crane legs.

They improve visibility to prevent
accidental bumping.

TR5750C

TR51200C

DESKTOP PRESSES

14

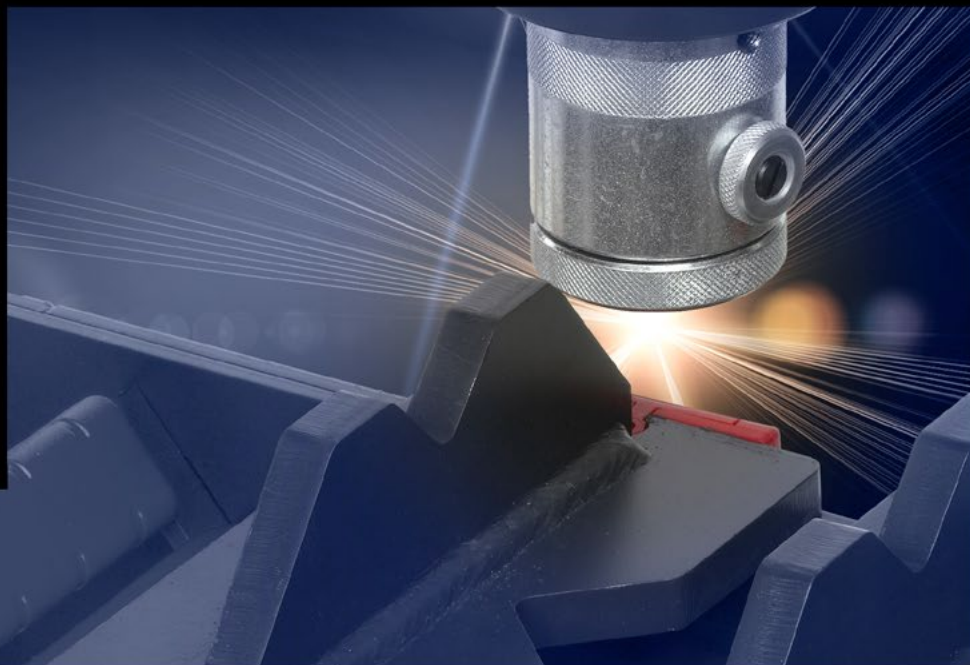

PRS_G LINE



Easy access to hydraulic components.

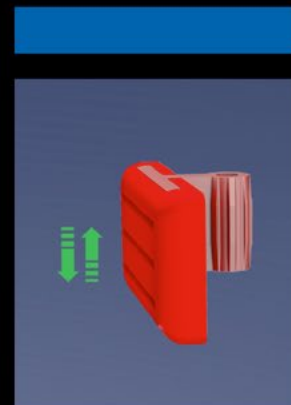

Guiding system.

DESKTOP PRESSES

- New, compact and functional design which integrates all the hydraulic elements within the chassis, provides a saving in the workshop space and ensures protection in transport.
- Supplied fully assembled and ready for work.
- Pressure gauge protected inside the frame.
- Workbench adjustable for height.
- Manual screw extension for quick approach and fine adjustment.



Safety overload valve.



Hydraulic stroke limitation.



Automatic spring return of piston.



Manometer.



BUREAU
VERITAS

Certificación
Oficial CE

CAP. (TON)	10	15
A	470	550
B	370	430
C	720	800
D	132	132
E	330	350
G1 Minimum	35	45
G2 Maximum	315	338
R1 Hydraulic stroke	86	95
R2 Extension stroke	75	75
R Total stroke	161	170
Weight (kg)	38	48

REF. PRS10G PRS15G

Measures in mm.

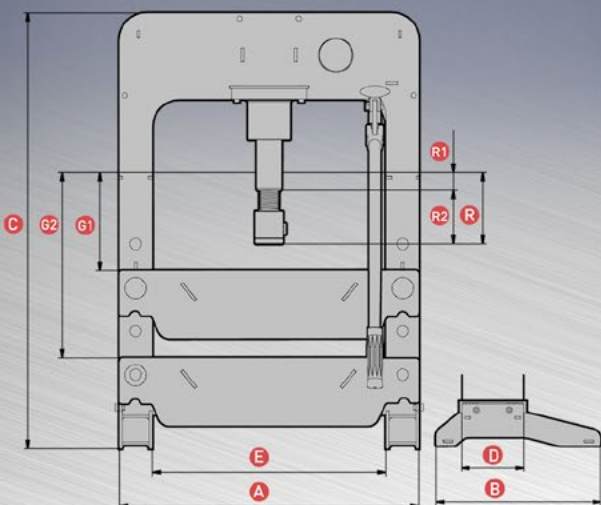

CE

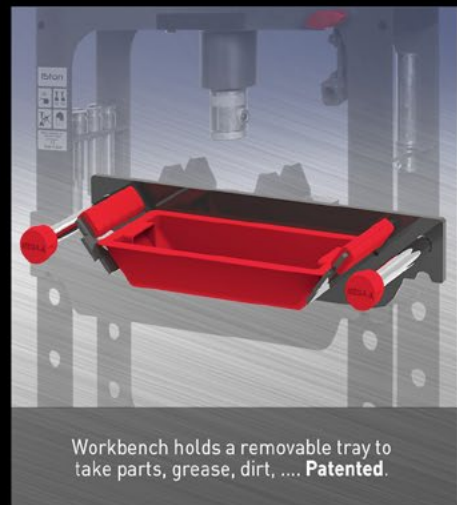
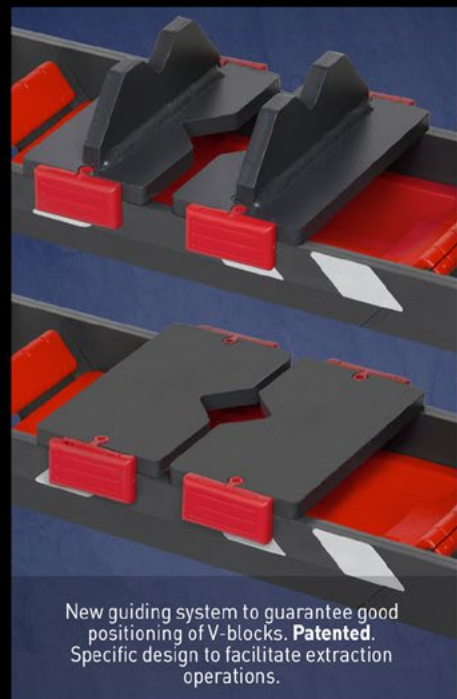

Set of punches is optional.



MEGA

Genuine since 1940

made in spain



PR510G

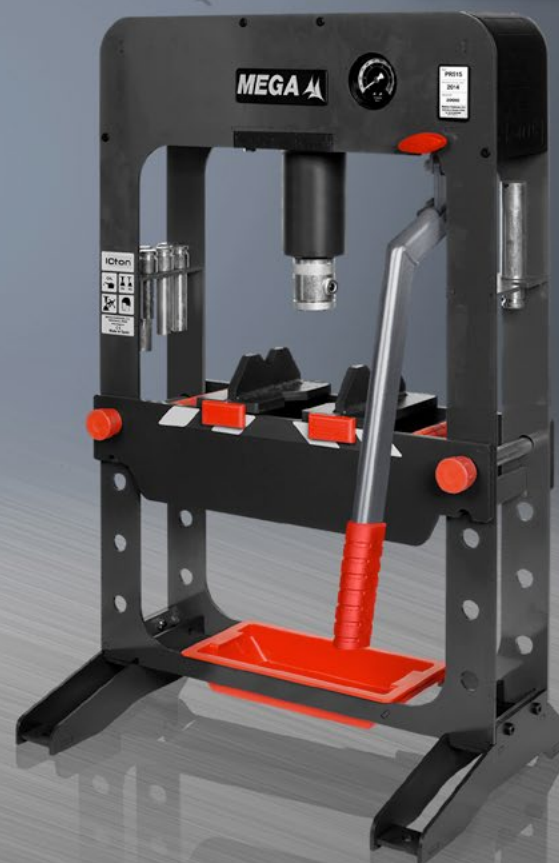

PR510G

PRESSES

15



Set of punches. **Optional.**



Easy access to hydraulic components.

PRB_G LINE

PRESSES

- Pressure gauge protected inside the frame.
- It is positioned at eye level to assist for easy reading.
- Supplied fully assembled and ready for work.
- Set of two V blocks included and legs with boltholes for fixing to the floor.
- Workbench adjustable for height.



Safety overload valve.



Hydraulic stroke limitation.



Automatic spring return of piston.



Manometer.

CAPACITY (t)	20	30
A	670	670
B	530	530
C	1850	1850
D	132	132
E	488	488
G1 Minimum	12	53
G2 Maximum	762	740
R1 Hydraulic stroke	150	150
R2 Extension stroke	75	75
R Total stroke	225	225
Weight (kg)	100	104

REFERENCES PRB20G PRB30G

Measures in mm.

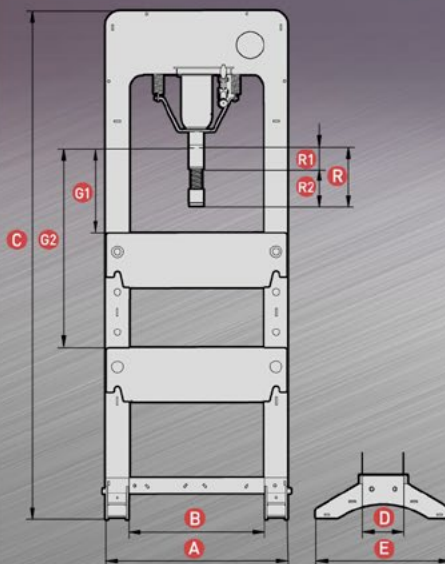

CE Official Certification



CE

MEGA

made in spain



Manual screw extension for quick approach and fine adjustment.

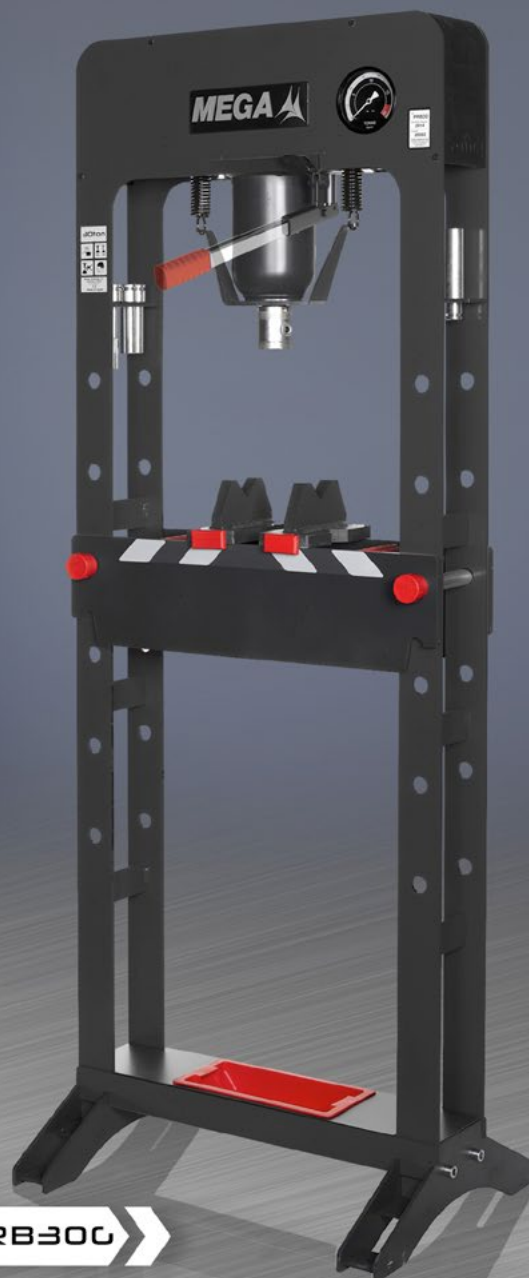

PRB300



PRB200

Legs with bolt holes for fixing to the floor or mounting of wheels. Removable tray.

PRESSES

16

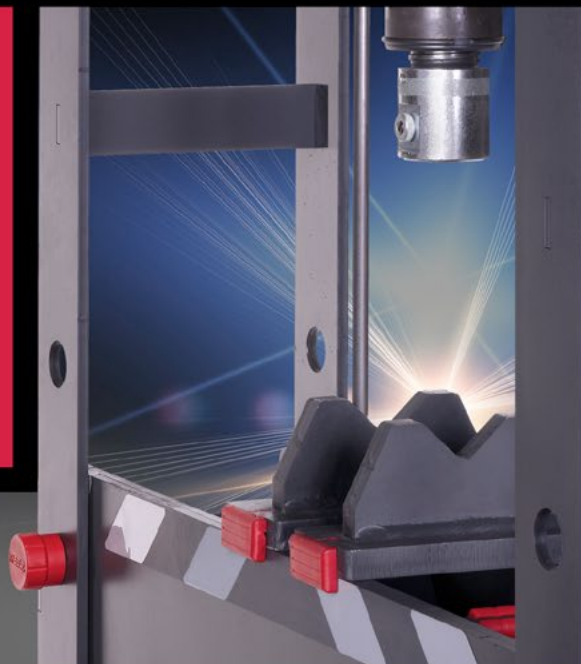

Easy access to hydraulic components.

PRC LINE

PRESSES

- Pressure gauge protected inside the frame. It is positioned at eye level to assist for easy reading.
- Different pump options: single or two speed manual, manual-pneumatic and electric pumps, depending on the working speed required.

CAPACITY (t)	20	30	50
A	670	670	670
B	530	530	530
C	1850	1850	1850
D	132	132	132
E	488	488	488
G1 Minimum	21	17	66
G2 Maximum	858	854	766
R1 Hydraulic stroke	120	120	120
R2 Extension stroke	75	75	75
R Total stroke	195	195	195
Weight (kg)	106	112	145

REFERENCES

Two piston manual pump	PRC20G	PRC30G	PRC50G
Manual and pneumatic hand pump	PRC20NG	PRC30NG	PRC50NG
Manual and pneumatic foot pump	PRC20NFG	PRC30NFG	PRC50NFG

Measures in mm.

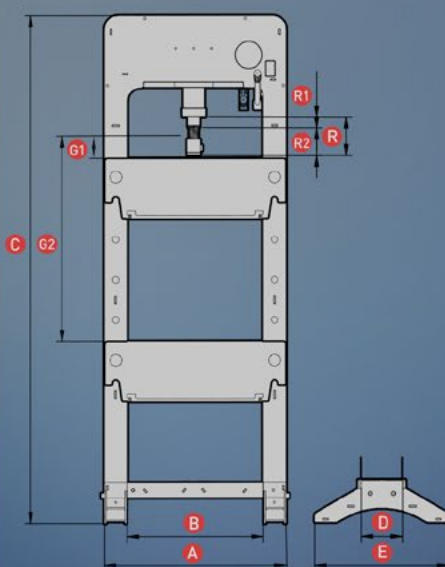

Safety overload valve.



Hydraulic stroke limitation.



Automatic spring return of piston.



Manometer.



BUREAU
VERITAS

CE Official
Certification





MEGA

made in spain



Pneumatic and manually operated pump.
The pneumatic control is operated by foot pedal.
legs with bolt holes for fixing to the floor
or mounting of wheels.

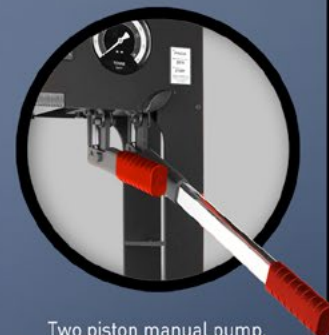
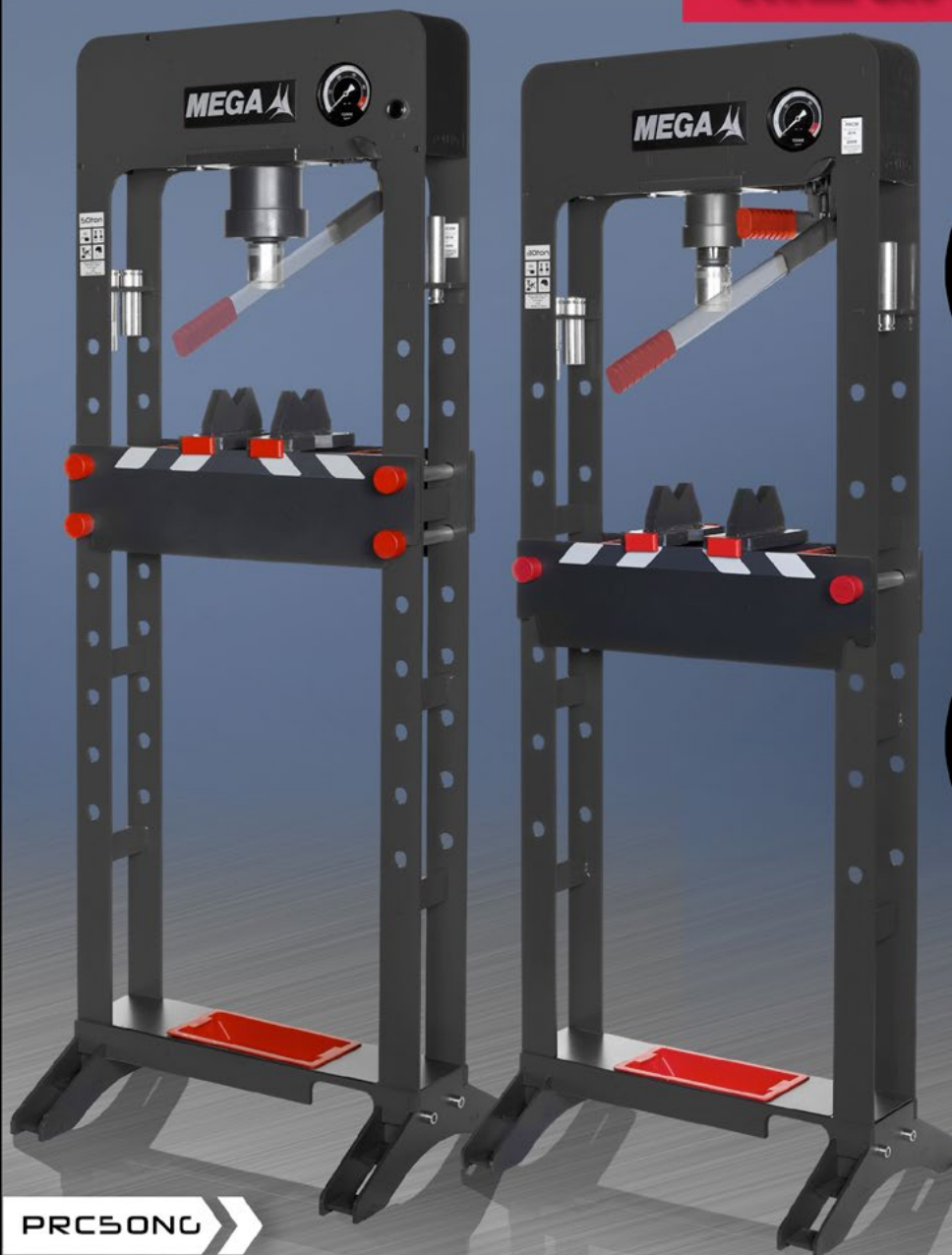

Two piston manual pump.
Fast approach pump and work
pressure pump.
(Mod. PRC30G)



Pneumatic and manually
operatd pump.
The pneumatic control is
manually operated.
(Mod. PRC50NG)

PRC50NG

PRC30G

Workbench holds a removable tray.
(See PRS_G line page)

PRESSES

17



Sliding cylinder all along the head on PRD_G models.



Winch to assist easy and quick positioning of the workbench.

PRD_G LINE

PRESSES

- Compact and functional design which integrates all the hydraulic elements within the chassis, provides a saving in the workshop space and ensures protection in transport.
- Supplied fully assembled and ready for work.
- Set of two V blocks included and legs with boltholes for fixing to the floor.

CAPACITY (t)	20	30	50
A	890	890	890
B	720	720	720
C	1900	1900	1900
D	150	150	150
E	490	490	490
G1 Minimum	84	84	84
G2 Maximum	770	770	770
R1 Hydraulic stroke	120	120	120
R2 Extension stroke	75	75	75
R Total stroke	195	195	195
M Lateral stroke	228	212	189
Weight (kg)	143	147	191

REFERENCES

Two piston manual pump	PRD20G	PRD30G	PRD50G
Manual and pneumatic hand pump	PRD20NG	PRD30NG	PRD50NG
Manual and pneumatic foot pump	PRD20NFG	PRD30NFG	PRD50NFG

Measures in mm.

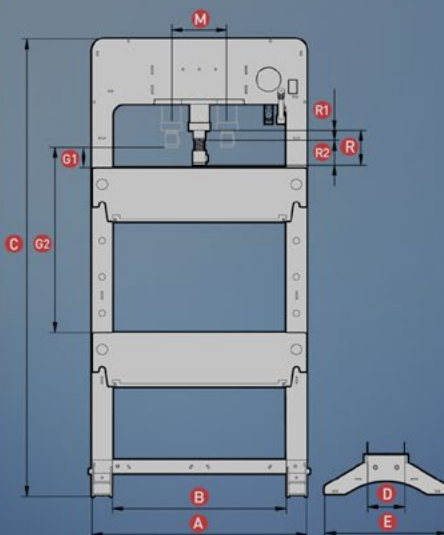

Safety overload valve.



Hydraulic stroke limitation.



Automatic spring return of piston.



Manometer.



CE Official Certification



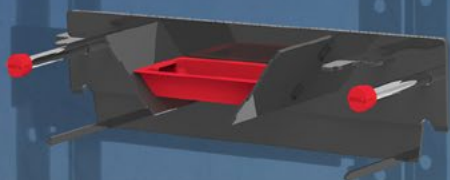

Workbench holds a removable tray to take parts, grease, dirt, ... **Patented.**



A-5611

Big removable tray. **Optional.**

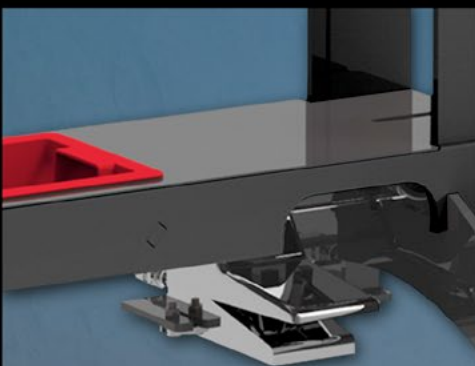

Detail of the pedal. (PRD50NFG model)

MEGA

Genuine since 1940

made in spain

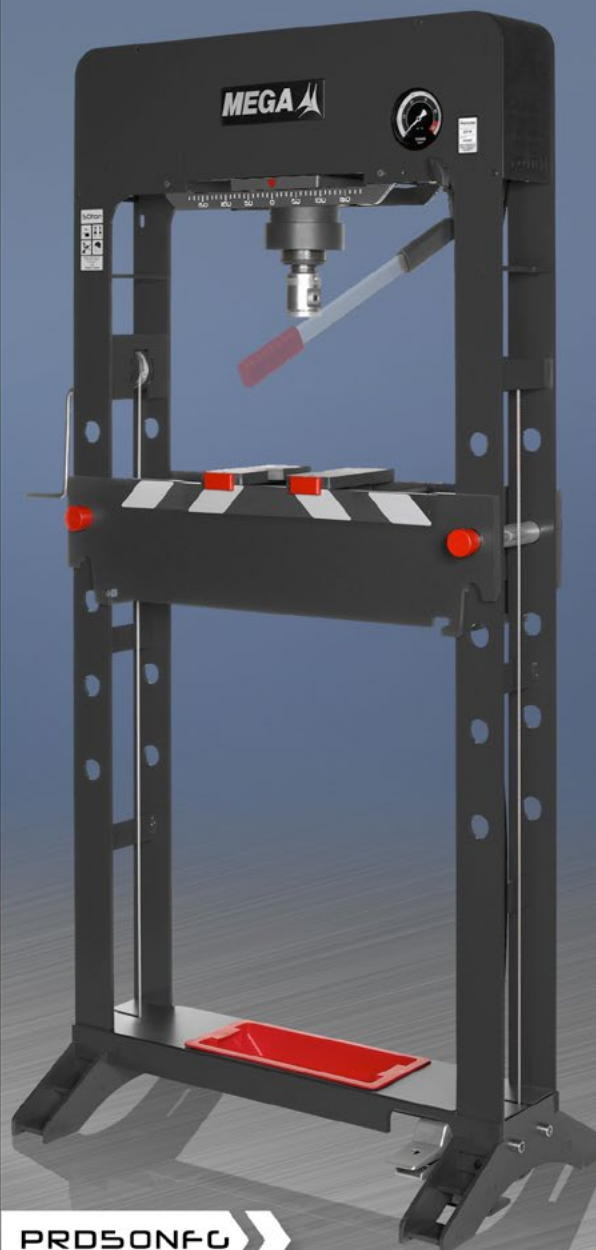

PRD50NFG



PRD20G

PRESSES

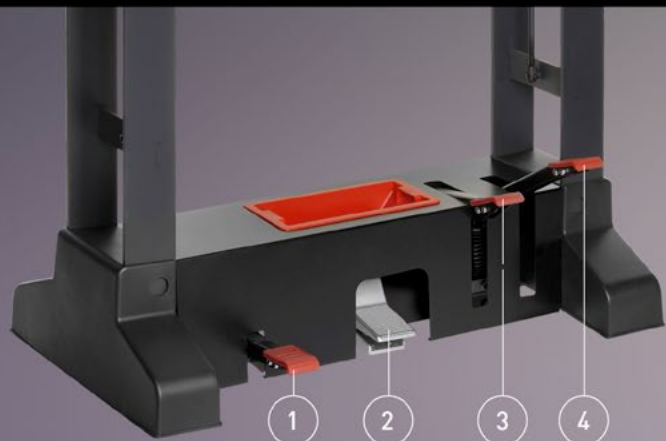

Detail of the pedals.

1. - Release pedal.
2. - Pneumatic operation pedal.
3. - Fast approach pedal.
4. - Pressure pedal.

18

CAP. (TON)	20	30	50
A	890	890	890
B	720	720	720
C	1920	1920	1920
D	195	195	195
E	490	490	490
G1 Minimum	105	85	80
G2 Maximum	490	470	465
R1 Hydraulic stroke	120	120	120
R2 Extension stroke	75	75	75
R Total stroke	195	195	195
M Lateral stroke	268	252	229
Weight (kg)	175	180	225

REF. PRP20G PRP30G PRP50G

Measures in mm.

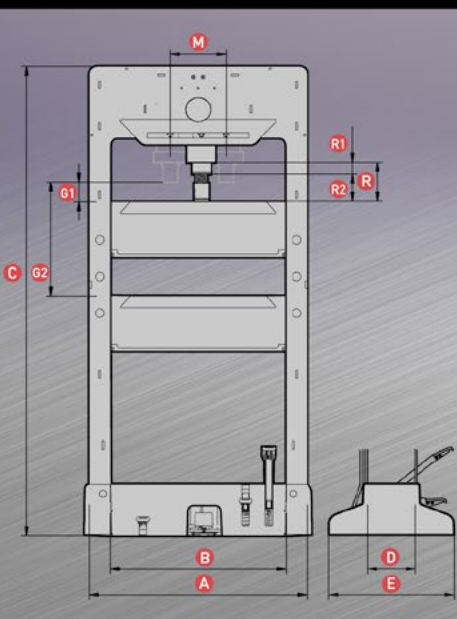

PRP_G LINE

PRESSES

(fully equipped - no options)

- Compact and functional design which integrates all the hydraulic elements within the chassis, provides a saving in the workshop space and ensures protection in transport.
- Supplied fully assembled and ready for work.
- Set of two V blocks included and legs with boltholes for fixing to the floor.
- Pressure gauge protected inside the frame. It is positioned at eye level to assist for easy reading.
- Different pump options: single or two speed manual, manual-pneumatic and electric pumps, depending on the working speed required.



Safety overload valve.



Hydraulic stroke limitation.



Automatic spring return of piston.



Manometer.



BUREAU
VERITAS

CE Official
Certification



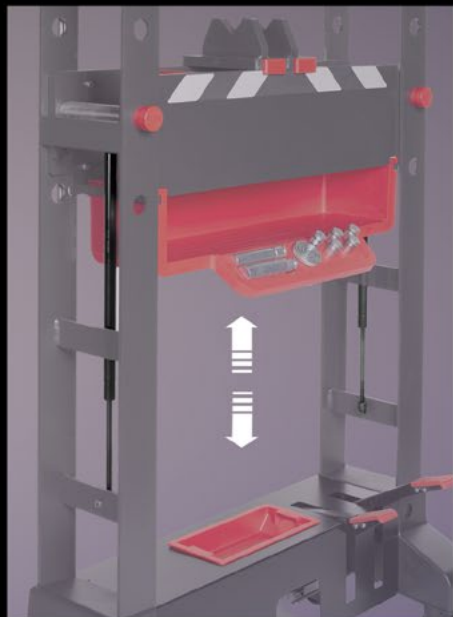

Working area free of winch cables. **Patented.**

Workbench floats freely on pneumatic manipulators. Faster and easier positioning of workbench.

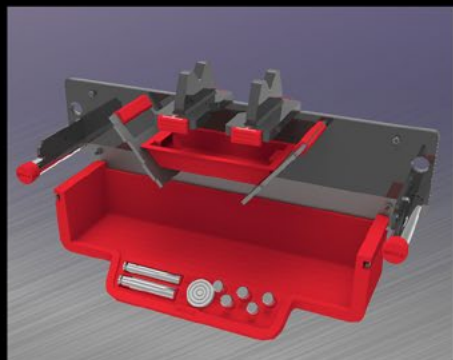

Adjustable table with removable tray.

All functions operated by foot allow the hands to be free for the job.



MEGA

Genuine since 1940

made in spain



PRESSES

19



Safety overload valve.



Hydraulic stroke limitation.



Automatic spring return of piston.



Manometer.

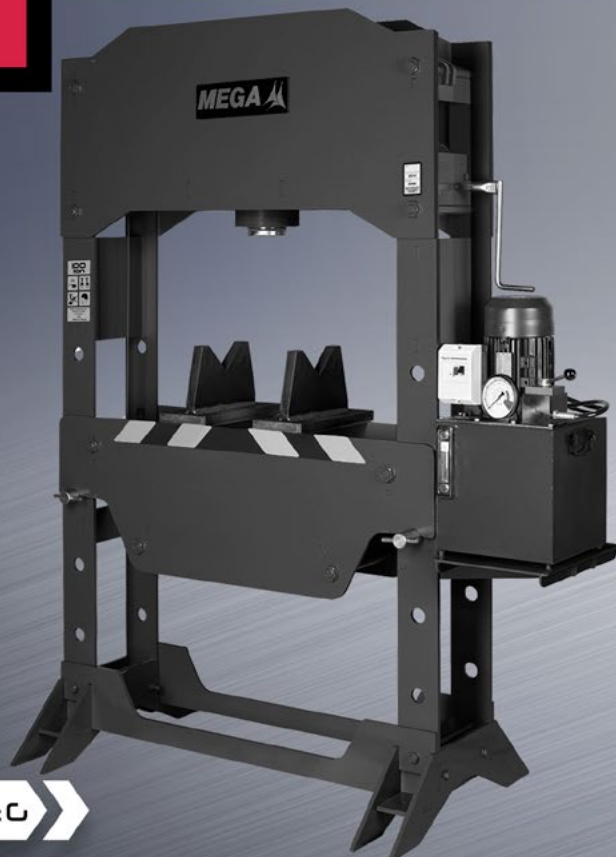

K100EC



The **K100G** press is equipped with a double-acting cylinder and two speed hand pump.

We do, however, recommend the electric pump as shown in the picture.

K_G LINE

PRESSES

- Compact and functional design which integrates all the hydraulic elements within the chasis, provides a saving in the workshop space and ensures protection in transport.
- Pressure gauge with damper to extend its working life. It is positioned at eye level to make for easy reading.
- Supplied fully assembled and ready for work. Set of two V blocks included. Workbench adjustable for height..
- Electric pump with asynchronous 4-pole, 1400 rpm motor.
- Double acting pump and control system. Safety on-off switch and oil level control.

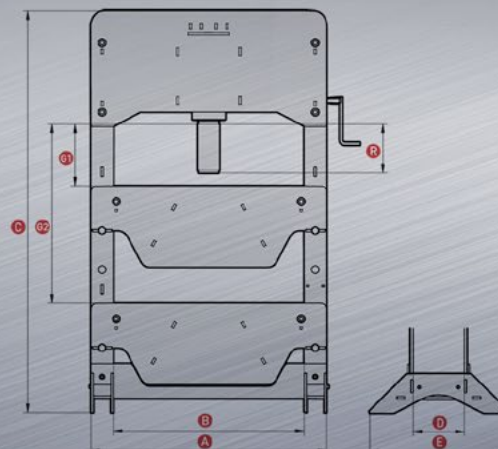

CAPACITY (t)		100
A		1200
B		715
C		2050
D		260
E		975
G1 Minimum		115
G2 Maximum		915
R Total stroke		250
Weight (kg)		620
REFERENCES		
With manual pump		K100G
With electric pump		K100EG

Measures in mm.

PR ACCESSORIES

MEGA 

Genuine since 1940

made in spain



A-5600
Set of punches.
Optional.

* Cylinders have a greater capacity than punches or V-blocks. A well balanced distribution of pressure on V-blocks is compulsory.



Safety overload valve.



Hydraulic stroke limitation.



Automatic spring return of piston.



Manometer.

Press protection. Two models (See next page)



A-5611

Big removable tray.
Optional.

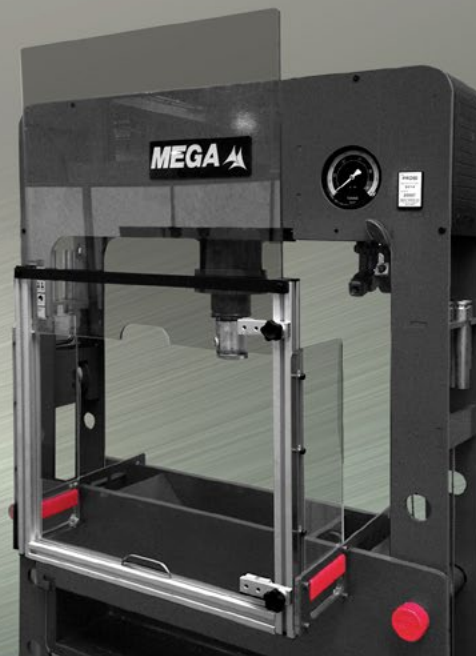

OPTIONS

OPTIONS

20

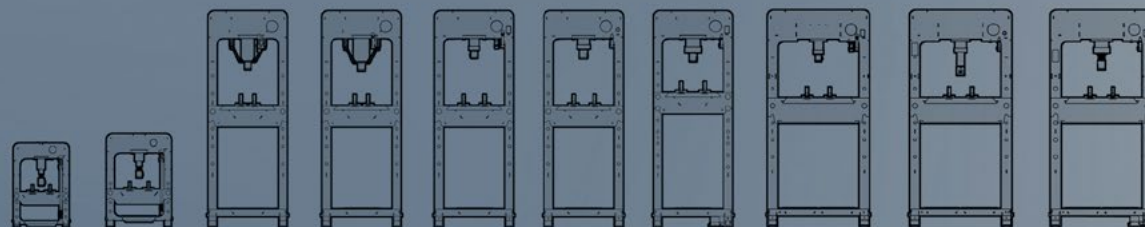

CAPACITY TON	10	15	20	30	20	30	50	20	30	50
MODEL	PRS_G		PRB_G		PRC_G			PRD_G		
	PRS10G	PRS15G	PRB20G	PRB30G						
Manometer	S	S	S	S	S	S	S	S	S	S
Extension screw	S	S	S	S	S	S	S	S	S	S
Removable tray	S	S	S	S	S	S	S	S	S	S
V-blocks	S	S	S	S	S	S	S	S	S	S
Simple pump	S	S	S	S	-	-	-	-	-	-
Winch	-	-	-	-	-	-	-	S	S	S
Sliding cylinder	-	-	-	-	-	-	-	S	S	S
Two piston pump: approach and pressure work	-	-	-	-	0 PRC20G	0 PRC30G	0 PRC50G	0 PRD20G	0 PRD30G	0 PRD50G
Single manual pump and pneumatic by hand	-	-	-	-	0 PRC20NG	0 PRC30NG	0 PRC50NG	0 PRD20NG	0 PRD30NG	0 PRD50NG
Single manual pump and pneumatic by foot	-	-	-	-	0 PRC20NFG	0 PRC30NFG	0 PRC50NFG	0 PRD20NFG	0 PRD30NFG	0 PRD50NFG
Electric pump	-	-	-	-	0 PRC20EG	0 PRC30EG	0 PRC50EG	0 PRD20EG	0 PRD30EG	0 PRD50EG
Broad tray	-	-	-	-	-	-	-	0 (A-5611)	0 (A-5611)	0 (A-5611)
Protection	-	-	0 (A-5613)	0 (A-5613)	0 (A-5613)	0 (A-5613)	0 (A-5613)	0 (A-5612)	0 (A-5612)	0 (A-5612)
Punches	0 (A-5600)	0 (A-5600)	0 (A-5600)	0 (A-5600)	0 (A-5600)	0 (A-5600)	0 (A-5600)	0 (A-5600)	0 (A-5600)	0 (A-5600)

S: Serie · 0: Optional · MODEL REFERENCE (ACCESORIES REFERENCE)

* Cylinders have a greater capacity than punches or V-blocks.

AIR HYDRAULIC JACKING BEAMS

CE **MA_G** LINE

MEGA

Genuine since 1940

made in spain

KG	2000	2000
A	1680	1680
B	885	885
C	340	340
D	100	100
E	830	792
F	1240	1202
G	220	220
H	490	490
J	30	160
Weight (kg)	129	125
REFERENCES	MA-26	MA-21G

Measures in mm.

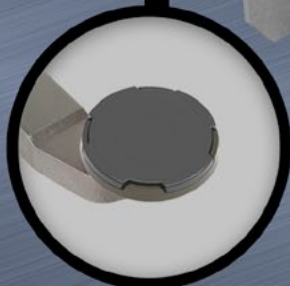
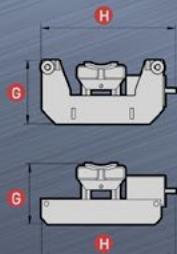
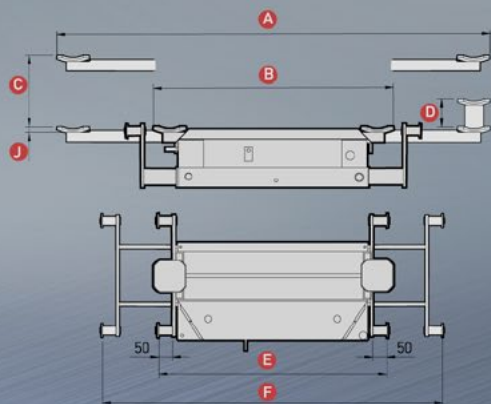

AIR HYDRAULIC JACKING BEAMS

- For use on four column lifting bridges or in pits.
- They are thereby indispensable for jobs such as wheel alignment, brake and suspension repairs,...
- They are suitable for any width of pit and rail.
- The extendable arms and extension lifting saddles facilitate the exact positioning of all vehicles. Sturdy construction.
- They can be supplied with either grooved or flat rollers upon request.
- We manufacture several versions depending on the end mounting brackets required.
- We present the two most popular models: MA-26 and MA-21G.

Air pressure required: 7-10 bar / 100-145 psi
Necessary air flow: 270 l/min / 9.5 cfm



Operation by the "dead man's" principle (the operation is halted if the user accidentally loses control)



Safety overload valve. Prevents the jack from being used beyond its rated capacity.



Hydraulic stroke limitation. Safety oil by-pass system prevents the ram from being over extended and causing damage to the cylinder.



LCS lowering system. A system that functions automatically and offers smooth and uniform lowering. It guarantees safe lowering in all circumstances, although an involuntary and/or abrupt and violent opening of the release valve is produced.

A-5270

ESSENTIAL!

Workshop in-line air filter-regulator-lubricator
Optional



PNEUMATIC PLATAFORM FOR MOTORCYCLES

CE

PTM_G LINE

21

PNEUMATIC PLATAFORM FOR MOTORCYCLES

- Air operated. Fitted with the fastest lifting speed in the market (from 3 to 8 seconds).
- Its adjustable safety lock sets the table at the desired working height and prevents from unforeseen descents.
- Manual control of descent speed. Delivered with a chain for a safe fixing of the front wheel
- Motorcycle repair and maintenance are comfortably done by using this lifting platform.



A-5270

ESSENTIAL!

Workshop in-line air filter-regulator-lubricator. **Optional.**



Operation by the "dead man's" principle (the operation is halted if the user accidentally loses control)



Safety overload valve. Prevents the jack from being used beyond its rated capacity.



Hydraulic stroke limitation. Safety oil by-pass system prevents the ram from being over extended and causing damage to the cylinder.



LCS lowering system. A system that functions automatically and offers smooth and uniform lowering. It guarantees safe lowering in all circumstances, although an involuntary and/or abrupt and violent opening of the release valve is produced.

Air pressure required: 7-10 bar / 100-145 psi
Necessary air flow: 270 l/min / 9.5 cfm

CAP. (Kg) 450

Weight (kg) 161,5

REF. **PTM-2G**

Measures in mm.

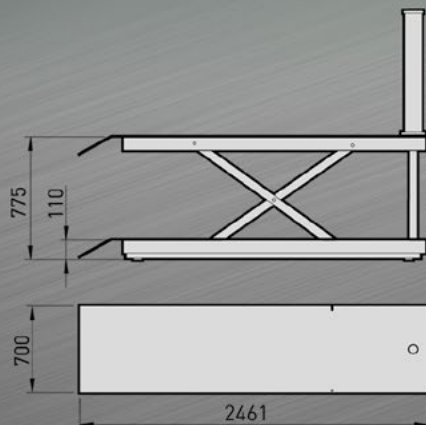

A-5099

Clamp device to clamp the motorcycle wheel to the table.
Optional.



PTM-2G



HYDRAULIC LIFTING TABLES

ME_G LINE

MEGA

Genuine since 1940

made in spain

HYDRAULIC LIFTING TABLES

- The rubber-coated handle facilitates easier operation.
- All models are fitted with polyamide wheels and castors to facilitate manoeuvrability.
- These wheels do not damage garage floors, do not rust and are quiet in operation.
- The table can be locked at different heights with safety bolts.



The wheels are fitted with foot protection and brakes.



Operation by the "dead man's" principle (the operation is halted if the user accidentally loses control)



Safety overload valve. Prevents the jack from being used beyond its rated capacity.



Hydraulic stroke limitation. Safety oil by-pass system prevents the ram from being over extended and causing damage to the cylinder.



LCS lowering system. A system that functions automatically and offers smooth and uniform lowering. It guarantees safe lowering in all circumstances, although an involuntary and/or abrupt and violent opening of the release valve is produced.

CAP. (kg)	650	1500	2500
A	215	210	300
B	645	880	880
C	830	1020	1060
D	500	500	540
E	1060	1380	1440
F	645	690	795
Weight (kg)	71	135	187
REF.	ME-650G	ME-1500G	ME-2500G

Measures in mm.

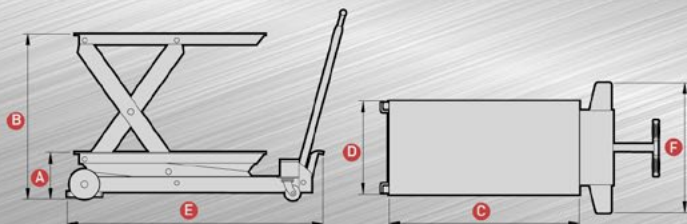

ME-2500G

WHEEL DOLLY

WHEEL DOLLY

- Manual support lever to reduce the lifting strain when working at maximum capacity.
- Fitted with chain to ensure safe movement of the wheel.
- Specially designed for removal of twin and large size wheels.

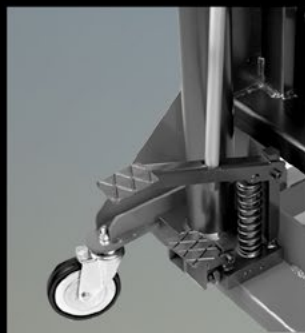

Lifting and lowering of the load using the foot pedals leave the hands free for the job.

Each arm includes two rollers to be able to turn the twin wheels on the truck independently.

Adjustable, five-position lifting arms.



SR700G

SR_G LINE



Operation by the "dead man's" principle (the operation is halted if the user accidentally loses control)



Safety overload valve. Prevents the jack from being used beyond its rated capacity.



Hydraulic stroke limitation. Safety oil by-pass system prevents the ram from being over extended and causing damage to the cylinder.



LCS lowering system. A system that functions automatically and offers smooth and uniform lowering. It guarantees safe lowering in all circumstances, although an involuntary and/or abrupt and violent opening of the release valve is produced.

CAP. (kg)	700
------------------	------------

Width range	480-750
-------------	---------

Min. height to fork	105
---------------------	-----

Maximum lift	630
--------------	-----

Weight (kg)	134
-------------	-----

REF.	SR700G
-------------	---------------

Measures in mm.

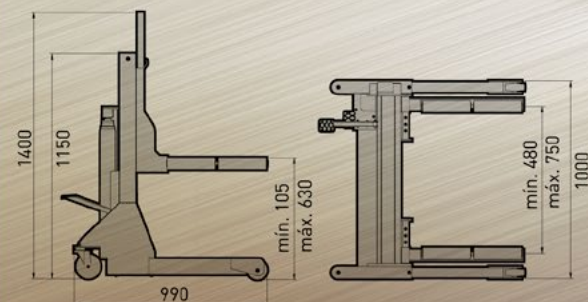

TRANSMISSION JACK

GCB LINE

MEGA

Genuine since 1940

made in spain



Safety overload valve.
Hydraulic stroke limitation.

TRANSMISSION JACK

- Particularly useful in the replacement of differential sets, transmission, gear boxes engines, etc, ...
- The saddle is fitted with chains to ensure safe movement of load.
- Equipped with a detachable pump, which allows the jack to be used in any position.



Safety overload valve. Prevents the jack from being used beyond its rated capacity.



Hydraulic stroke limitation. Safety oil by-pass system prevents the ram from being over extended and causing damage to the cylinder.

CAP. (Kg) 1000

Weight (kg) 86

REF. GCB-20

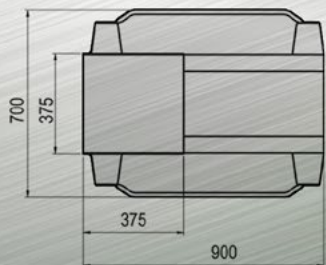
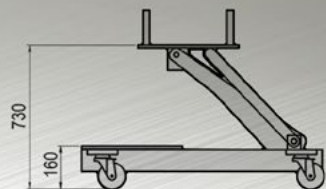

GCB-20

BODY ALIGNING SET

CE EHA_G LINE

BODY ALIGNING SET

- This set has been designed to carry out repairs on badly-damaged cars.
- This articulated body, it offers great performance as it allows pulling from different angles.



NS-1
Air-powered pump. **Optional.**



Safety overload valve. Prevents the jack from being used beyond its rated capacity.



Hydraulic stroke limitation. Safety oil by-pass system prevents the ram from being over extended and causing damage to the cylinder.



Automatic spring return of piston.

As an option, it can be equipped with NS-1 (pneumatic) foot pedal pump, which will leave the hands free for the job.

IMPORTANT: The maximum working load of the chain is 1,4t.

ACCESSORIES EHA-10G

Nº	REF.	Nº	REF.
1	BM-04	7	S-21
2	CC-10-B	8	A-5087
3	A-5541	9	A-1512
4	A-5096	10	A-1513
5	A-5095	11	A-5088
6	A-5094	12	A-5089

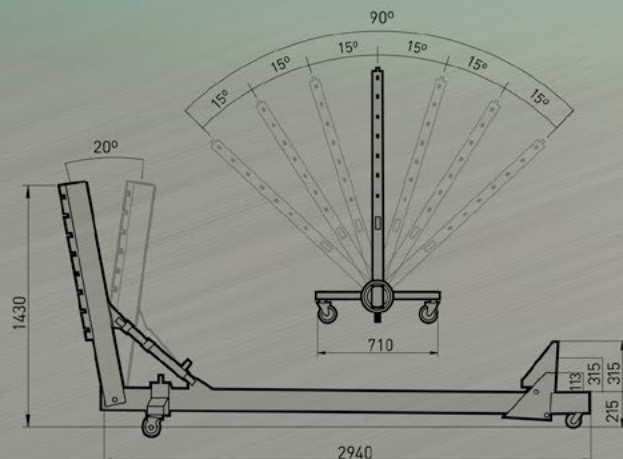

CAP. (TON) 10

Weight (kg) 178,5

REF. EHA-10G

EHA-10G

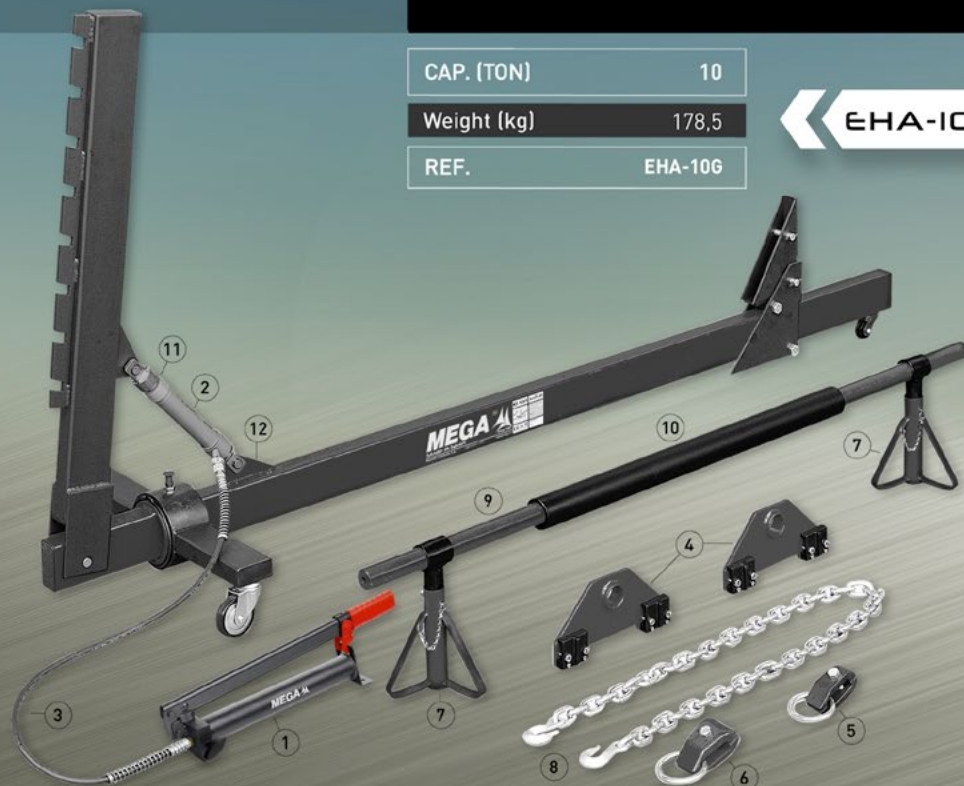

BODY REPAIR KITS

CC LINE

MEGA

Genuine since 1940

made in spain



CT-5 • Pulling cylinder. **Optional.**

REF.:	Mod.	Cap.(t).	Rec. (mm)
CT-5	GC-10	5	138
CT-10	GC-20	10	138

BODY REPAIR KITS

- The most complete body repair kit due to the number and variety of accessories.
- **Important advantage:** safer and more sturdy thanks to the threaded connections which allow pulling operations, compared with other more extensive but less reliable connection systems in the market which only allow pushing operations.
- Indispensable for jobs such as body repairs, rescue and roadside service or any other pushing, pulling, spreading or lifting applications that require hydraulic force.
- **IMPORTANT:** As the cylinders have a greater capacity than the components, namely chains, cylinder toes, tube extensions, etc., they should never exceed half their rated capacity.
- The maximum capacity of the SH-1 spreading cylinder is 1t. Maximum working load of the chain: 1t.
- Safety overload valve. Hydraulic stroke limitation. Piston retracts by spring.



CAP. (TON)	10	20
1	BM-04	BM-04
2	CC-10-B	CC-20-B
3	GC-10/2272	A-5167
4	A-5541	A-5541
5	A-5033 / Ø 42 L 700	A-5233 / Ø 60 L 700
6	A-5034 / Ø 42 L 480	A-5234 / Ø 60 L 460
7	A-5035 / Ø 42 L 230	A-5235 / Ø 60 L 255
8	A-5048	
9	A-5042	A-5242
10	A-5038	A-5238
11	A-5053	
12	A-5054	
13	A-5055	A-5284*
REF.	GC-10	GC-20

CAP. (TON)	10	20
14	A-5050	A-5280*
15	A-5039	A-5239
16	A-5036 / Ø 42 L 130	
17	A-5049	
18	SH-1	
19	A-5043	
20	A-5086	
21	A-5057	
22	A-5058	
23	A-5056	
24	A-5051	A-5252 *
25	A-5052	
PESO (kg)	45	45
REF.	GC-10	GC-20

* These components have a different design to that shown in the picture.



AXLE STANDS



C LINE

24

AXLE STANDS

- Car stands to secure loads, as an indispensable safety measure.
- Providing great stability and wide feet to protect the workshop floor.
- The pin can rest on the base or go through it.

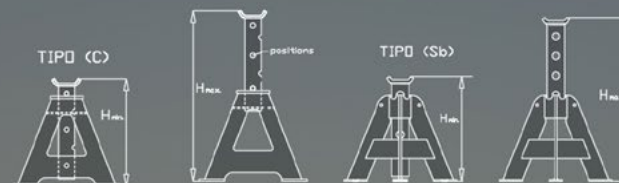

REF.:	Cap. (t)	H min.	H max.	N° posit.	Weight (kg)
C6	6	360	520	5	6
C10	10	375	550	5	10,5
S15B	15	340	532	4	9,3

Pin secured to the stand to avoid loss.

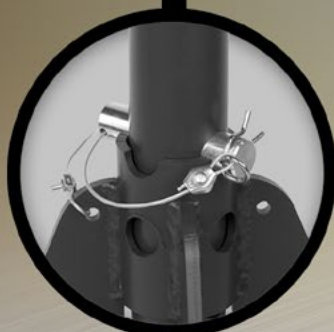

C6

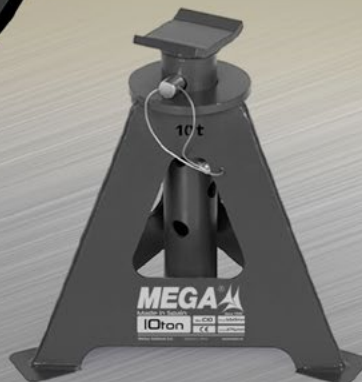

C10



S15B

TOE JACK

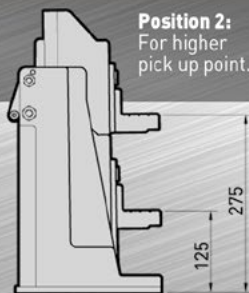
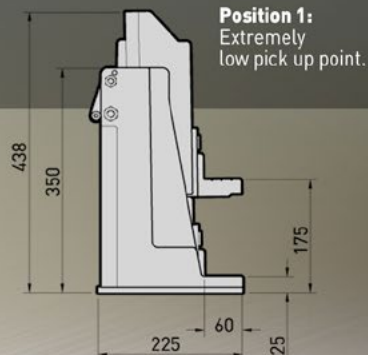
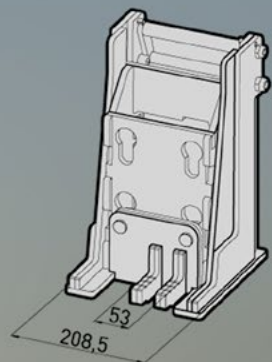

BL LINE

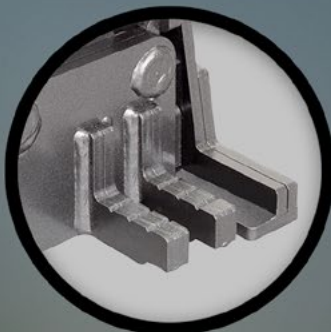

Extra low profile lifting toe (25 mm)



BL10

MEGA

Genuine since 1940

made in spain

TOE JACK

- This is the combination of BL10 heavy-duty structure and BR10G bottle jack. (Can also be used with BR8G bottle jack).
- Ideal for difficult lifting, supporting, levelling or positioning of fork-lifts, heavy machines and numerous jobs where space is tight.
- The toe is detachable and adjustable to 2 fixing positions.



HYDRAULIC PIPE BENDERS



25



HYDRAULIC PIPE BENDERS

- Bending work can be carried out without physical effort thanks to the high force of the hydraulic unit and the extension of leverage allowed by the telescopic handle.
- Fitted with retractable bending frame, indelibly marked, to facilitate easier positioning of bending supports and pipe.
- "V" shape frame design, showing the 90° degree angle reference, reduce hydraulic stroke and save bending time.
- For water pipe, DIN 2440 and DIN 2441. Maximum bending angle: 180°.
- **DR2** supplied in a plastic case, with tripod stand and complete instructions for use, maintenance and bending work.
DR3 supplied in a wooden case.



Safety overload valve.



Hydraulic stroke limitation.



Automatic spring return of piston.

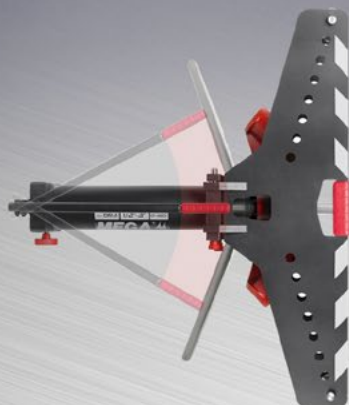

Telescopic swivel pump handle.



Supplied with the following sets of formers:

DR2: 1/2" - 3/4" - 1" - 1 1/4" - 1 1/2" - 2".

DR3: 1/2" - 3/4" - 1" - 1 1/4" - 1 1/2" - 2" - 2 1/2" - 3".



Pipes up to	2"	3"
Weight (kg)	43	86,5
REF.	DR2	DR3

DR2 supplied in a plastic case.
DR3 supplied in a wooden case.



Smart weight distribution allows more comfortable transport.
More transport options thanks to the rollers inside the pump frame.

MEGA

Genuine since 1940

made in spain

DR LINE



DR2



DR3



MELCHOR GABILONDO, S.A.

Polígono Industrial Eitua, 6 - 48240 BERRIZ (VIZCAYA) SPAIN

Tel.: + 34 94 622 50 90 / Fax: + 34 94 622 52 78

Tel. ventas nacionales: 94 622 50 30 / Fax ventas nacionales: 94 682 73 50

E-mail Export: export@mega.es

E-mail National: interior@mega.es

www.mega.es

